

MOL "MOLLY" steel anchor



Description

For medium duty fixing of interior finish products in plasterboards and cavity materials.

Material: steel.

Protective coating

Zinc chromate coating

Features and advantages of the product

Secure fixing Sharp flange barbs prevent the rotation of anchor shell during fixing which, ensures correct installation.

Anchor design After being fixed, collapsing arms form a large support surface on the reverse side of the plasterboard.

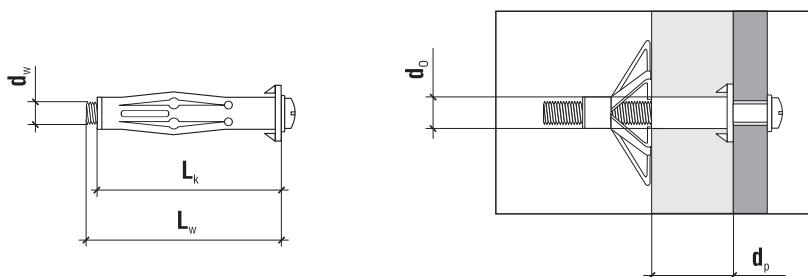

	Code	Bolt diameter and length $d_w \times L_w$ [mm]	Drill hole diameter d_o [mm]	Shank length L_k [mm]	Drywall thickness range d_p [mm]	Pcs.
ø4.0	MOL-04025	M4 x 25	9	19	2 - 6	100
	MOL-04038	M4 x 38	9	32	6 - 12	100
	MOL-04045	M4 x 45	9	38	13 - 16	100
	MOL-04052	M4 x 52	9	45	20 - 24	100
	MOL-04065	M4 x 65	9	54	27 - 33	100
ø5.0	MOL-05045	M5 x 45	11	37	6 - 12	100
	MOL-05058	M5 x 58	11	52	12 - 16	50
	MOL-05071	M5 x 71	11	65	24 - 32	50
	MOL-05088	M5 x 88	11	80	38 - 45	50
ø6.0	MOL-06045	M6 x 45	13	37	7 - 12	50
	MOL-06058	M6 x 58	13	52	10 - 16	50
	MOL-06071	M6 x 71	13	65	24 - 32	50
	MOL-06088	M6 x 88	13	80	38 - 45	50

Installation

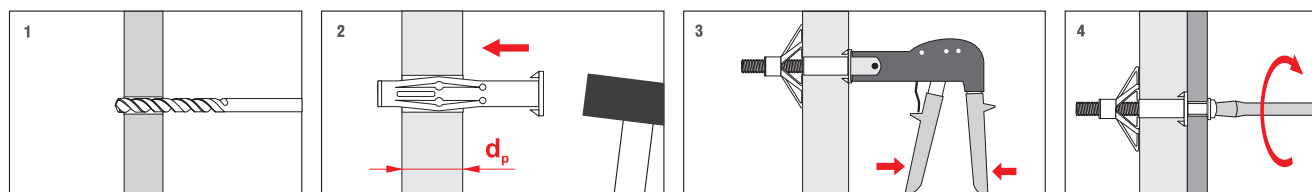

DRYWALL FASTENER SYSTEMS

PLUGS AND ANCHORS FOR FIXING DRYWALL SYSTEMS

RESISTANCE

Code and size	Characteristic/design resistance in 9.5 mm plasterboard [kN]	Characteristic/design resistance in 12.5 mm plasterboard [kN]	Characteristic/design resistance in 2x12.5 mm plasterboard [kN]	Characteristic/design resistance in 10 mm chipboard [kN]
MOL-M4	0.37 / 0.17	0.40 / 0.18	0.46 / 0.21	0.62 / 0.28
MOL-M5	0.53 / 0.24	0.78 / 0.35	0.86 / 0.39	1.28 / 0.58
MOL-M6	0.60 / 0.27	0.95 / 0.43	1.40 / 0.63	1.95 / 0.88

Plasterboards according to PN-EN 520:2005 ;PN-B-79405:1997/Ap1:1999
Chipboards according to PN-EN 312:2005

